

Filter Drier solid Core C Series Parker Sporlan Catch-All®



Parker Sporlan Catch-All® C Series liquid line filters driers ensure the protection of the refrigeration and air-conditioning systems from moisture, acids, and solid particles.

Catch-All® liquid filter driers contain unique moulded porous core, consisting of a blend of highly effective desiccants. They are unexcelled in moisture removal and acid retention.

The famous moulded porous core of the Catch-All® Filter-Drier performs these vital functions and improves the life cycle of all thermodynamic systems.

Benefits

| | |
|-----------------------------|---------------------------|
| Max Working Pressure | 44.8bar (650 psig) |
| Temperature Range | -40°C up to +66°C |

- **Leak Testing:** 45 bar in a pool
- **Coating:** Polyester Winter Gray 10-7069 is a U.L recognized high gloss epoxy powder coating
- **Filtration:** 20 microns
- **Approvals:** UL file no. SA-1756A & B. PED 97/23/EC - article 3.3

The physical size of the C Series Catch-All® filter driers range allows the product to be manufactured under the PED category (art.3.3) which does not require the "CE" marking.

Technical Data

Catch-All®

Drying capacity - kg of refrigerant*

| C Series | R134a | | R404A R507 | | R407C | | R410A | | R 22 | |
|----------|-------|------|------------|------|-------|------|-------|------|------|------|
| | 24°C | 52°C | 24°C | 52°C | 24°C | 52°C | 24°C | 52°C | 24°C | 52°C |
| C 03 | 3.4 | 2.4 | 3.6 | 2.9 | 2.6 | 0.9 | 1.4 | 1.0 | 3.1 | 2.5 |
| C 05 | 7.9 | 5.7 | 8.5 | 6.9 | 6.2 | 2.0 | 3.2 | 2.4 | 7.3 | 6.0 |
| C 08 | 13.1 | 9.4 | 14.0 | 11.4 | 10.1 | 3.3 | 5.2 | 3.9 | 12.0 | 9.8 |
| C 16 | 19.8 | 14.3 | 21.2 | 17.3 | 15.4 | 5.0 | 7.9 | 6.0 | 18.2 | 14.9 |
| C 30 | 37.8 | 27.3 | 40.5 | 32.9 | 29.3 | 9.5 | 15.1 | 11.4 | 34.8 | 28.4 |
| C 41 | 50.9 | 36.7 | 54.4 | 44.3 | 39.4 | 12.7 | 20.4 | 15.3 | 46.8 | 38.2 |
| C 60 | 75.6 | 54.5 | 80.9 | 65.8 | 58.6 | 18.9 | 30.2 | 17.7 | 69.6 | 56.7 |

(*) Drying capacity is the result of standard tests before and after drying from 1050ppm to 50ppm

For all requests, consult your nearest Parker Sporlan Wholesaler or contact us on: racecustomerservice@parker.com / www.parker.com/race

Technical Data

Catch-All® Flare (SAE) Connections

| Part Number | C Series | Connections SAE | Flow Capacity (kW) (1) | | | | Dimensions (mm) | | Weight kg |
|-------------|----------|-----------------|------------------------|-------------|------------|-------|-----------------|----|-----------|
| | | | R22 | R134a R407C | R404A R507 | R410A | L | D1 | |
| 400000 | C-032 | 1/4" | 5.26 | 4.57 | 3.52 | 4.92 | 106 | 44 | 0.227 |
| 400032 | C-032-FM | 1/4" | 5.26 | 4.57 | 3.52 | 4.92 | 97 | 44 | 0.227 |
| 400088 | C-033 | 3/8" | 12.30 | 11.30 | 8.09 | 12.00 | 119 | 44 | 0.227 |
| 400200 | C-052 | 1/4" | 7.39 | 6.68 | 4.92 | 7.03 | 121 | 62 | 0.340 |
| 400224 | C-052-FM | 1/4" | 7.39 | 6.68 | 4.92 | 7.03 | 106 | 62 | 0.340 |
| 400288 | C-053 | 3/8" | 14.40 | 15.10 | 10.90 | 15.80 | 132 | 62 | 0.340 |
| 400416 | C-082 | 1/4" | 7.39 | 6.68 | 4.92 | 7.03 | 143 | 67 | 0.567 |
| 400472 | C-083 | 3/8" | 15.80 | 14.80 | 10.60 | 15.50 | 154 | 67 | 0.567 |
| 400536 | C-084 | 1/2" | 30.60 | 17.80 | 20.70 | 29.90 | 160 | 67 | 0.567 |
| 401000 | C-162 | 1/4" | 7.39 | 6.68 | 4.92 | 7.03 | 159 | 76 | 0.794 |
| 401048 | C-163 | 3/8" | 15.80 | 14.80 | 10.60 | 15.50 | 171 | 76 | 0.794 |
| 401128 | C-164 | 1/2" | 35.50 | 32.70 | 23.90 | 34.20 | 176 | 76 | 0.794 |
| 401216 | C-165 | 5/8" | 48.50 | 44.30 | 32.40 | 47.10 | 184 | 76 | 0.794 |
| 401328 | C-303 | 3/8" | 16.20 | 14.80 | 10.60 | 15.50 | 246 | 76 | 1.588 |
| 401360 | C-304 | 1/2" | 35.50 | 32.70 | 23.90 | 34.50 | 251 | 76 | 1.588 |
| 401408 | C-305 | 5/8" | 52.40 | 47.80 | 34.80 | 51.00 | 259 | 76 | 1.588 |
| 401624 | C-414 | 1/2" | 40.50 | 36.90 | 26.70 | 39.00 | 252 | 89 | 2.040 |
| 401656 | C-415 | 5/8" | 55.60 | 51.00 | 37.30 | 54.20 | 260 | 89 | 2.040 |

(1) Liquid capacity in accordance with ARI 710-86 standard.
 Te = -15°C, Tc = 30°C, Δp = 0.07 bar (1 psig).
 FM= Female / Male.
 Other working conditions see pages 223 to 225.

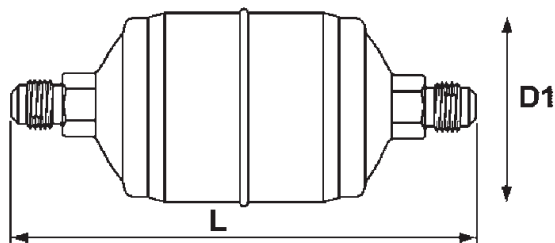

Accurate at the time of going to print.

For all requests, consult your nearest Parker Sporlan Wholesaler or contact us on:
racecustomerservice@parker.com / www.parker.com/race

Technical Data

Catch-All® ODF Solder Connections

| Part Number | C Series | Connections ODF | Flow Capacity (kW) (1) | | | | Dimensions (mm) | | | Weight kg |
|-------------|----------|-----------------|------------------------|----------------|---------------|--------|-----------------|-----|----|-----------|
| | | | R22 | R134a R407C | R404A R507 | R410A | L | A | D1 | |
| 400052 | C-032-S | 1/4" | 5.26 | 4.57 | 3.52 | 4.92 | 97 | 77 | 44 | 0.227 |
| 400001 | C-033-S | 3/8" | 13.40 | 12.30 | 9.14 | 13.00 | 99 | 77 | 44 | 0.227 |
| 400249 | C-052-S | 1/4" | 7.39 | 6.68 | 4.92 | 7.03 | 106 | 86 | 62 | 0.34 |
| 400329 | C-053-S | 3/8" | 16.50 | 15.10 | 10.90 | 15.80 | 109 | 87 | 62 | 0.34 |
| 400429 | C-082-S | 1/4" | 7.39 | 6.68 | 4.92 | 7.03 | 130 | 110 | 67 | 0.567 |
| 400503 | C-083-S | 3/8" | 18.30 | 16.50 | 12.00 | 17.60 | 133 | 111 | 67 | 0.567 |
| 400437 | C-084-S | 1/2" | 33.80 | 30.90 | 22.50 | 33.10 | 138 | 112 | 67 | 0.567 |
| 401018 | C-162-S | 1/4" | 7.39 | 6.68 | 4.92 | 7.03 | 146 | 126 | 76 | 0.794 |
| 401021 | C-163-S | 3/8" | 18.30 | 16.50 | 12.00 | 17.60 | 149 | 127 | 76 | 0.794 |
| 401023 | C-164-S | 1/2" | 38.70 | 35.50 | 25.70 | 37.60 | 152 | 126 | 76 | 0.794 |
| 401035 | C-165-S | 5/8" | 55.90 | 51.00 | 37.30 | 54.50 | 160 | 128 | 76 | 0.794 |
| 401305 | C-303-S | 3/8" | 18.60 | 16.50 | 12.00 | 17.60 | 226 | 204 | 76 | 1.588 |
| 401307 | C-304-S | 1/2" | 38.70 | 35.50 | 25.70 | 37.60 | 229 | 203 | 76 | 1.588 |
| 401449 | C-305-S | 5/8" | 59.40 | 54.50 | 39.70 | 57.70 | 235 | 203 | 76 | 1.588 |
| 401505 | C-307-S | 7/8" | 76.00 | 69.60 | 50.60 | 73.90 | 249 | 211 | 76 | 1.588 |
| 401609 | C-414-S | 1/2" | 48.60 | 40.10 | 29.20 | 42.60 | 230 | 204 | 89 | 2.04 |
| 401610 | C-415-S | 5/8" | 61.50 | 56.60 | 41.50 | 60.10 | 237 | 205 | 89 | 2.04 |
| 401614 | C-417-S | 7/8" | 77.70 | 71.40 | 52.00 | 75.60 | 249 | 211 | 89 | 2.04 |
| 401618 | C-419-S | 1-1/8" | 85.50 | 78.40 | 57.30 | 83.40 | 248 | 200 | 89 | 2.04 |
| 401837 | C-607-S | 7/8" | 102.00 | 93.60 | 68.60 | 100.00 | 406 | 368 | 76 | 2.72 |
| 401865 | C-609-S | 1-1/8" | 117.00 | 107.00 | 78.40 | 114.00 | 406 | 356 | 76 | 2.72 |

(1) Liquid capacity in accordance with ARI 710-86 standard.
 Te = -15°C, Tc = 30°C, Δp = 0.07 bar (1 psig).

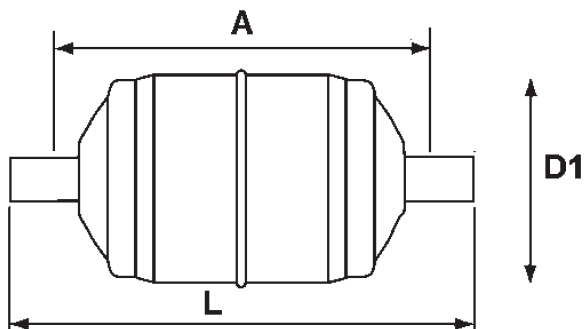

For all requests, consult your nearest Parker Sporlan Wholesaler or contact us on:
racecustomerservice@parker.com / www.parker.com/race